

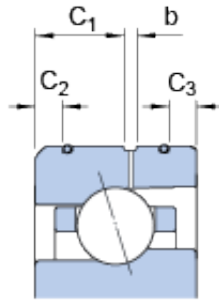

NTN BEARING CORP.

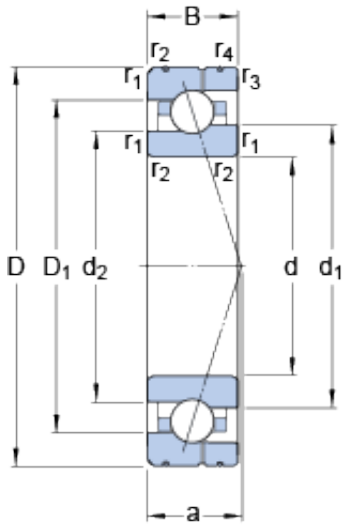

45 mm x 75 mm x 16 mm SKF 7009 CE/P4AL
angular contact ball bearings

Bearing No. 7009 CE/P4AL

7009 CE/P4AL Bearing 2D drawings and 3D CAD models

Size	75x45x16 mm
Bore Diameter	75 mm
Outer Diameter	45 mm
Width	16 mm
d	45 mm
D	75 mm
B	16 mm
d ₁	55.7 mm
d ₂	53.6 mm
D ₁	64.25 mm
b	1.7 mm
C ₁	8.6 mm
C ₂	3 mm
C ₃	3 mm
r _{1,2} - min.	1 mm
r _{3,4} - min.	0.6 mm
a	16.1 mm
d _a - min.	49.6 mm
d _b - min.	49.6 mm
D _a - max.	70.4 mm
D _b - max.	70.8 mm
r _a - max.	1 mm
r _b - max.	0.6 mm
d _n	57.6 mm



NTN BEARING CORP.

Basic dynamic load rating - C	13 kN
Basic static load rating - C ₀	8.5 kN
Fatigue load limit - P _u	0.36 kN
Limiting speed for grease lubrication	27000 r/min
Limiting speed for oil lubrication	41000 mm/min
Ball - D _w	7.144 mm
Ball - z	21
G _{ref}	3.4 cm ³
Calculation factor - f ₀	8.2
Preload class A - G _A	70 N
Preload class B - G _B	210 N
Preload class C - G _C	410 N
Calculation factor - f	1.06
Calculation factor - f	1
Calculation factor - f _{2A}	1
Calculation factor - f _{2B}	1.03
Calculation factor - f _{2C}	1.05
Calculation factor - f _{HC}	1
Preload class A	38 N/micron
Preload class B	59 N/micron
Preload class C	79 N/micron
d ₁	55.7 mm
d ₂	53.6 mm
D ₁	64.25 mm
C ₁	8.6 mm
C ₂	3 mm
C ₃	3 mm
r _{1,2} min.	1 mm



NTN BEARING CORP.

$r_{3,4}$ min.	0.6 mm
d_a min.	49.6 mm
d_b min.	49.6 mm
D_a max.	70.4 mm
D_b max.	70.8 mm
r_a max.	1 mm
r_b max.	0.6 mm
d_n	57.6 mm
Basic dynamic load rating C	13 kN
Basic static load rating C_0	8.5 kN
Fatigue load limit P_u	0.36 kN
Attainable speed for grease lubrication	27000 r/min
Attainable speed for oil-air lubrication	41000 r/min
Ball diameter D_w	7.144 mm
Number of balls z	21
Reference grease quantity G_{ref}	3.4 cm ³
Preload class A G_A	70 N
Static axial stiffness, preload class A	38 N/ μ m
Preload class B G_B	210 N
Static axial stiffness, preload class B	59 N/ μ m
Preload class C G_C	410 N
Static axial stiffness, preload class C	79 N/ μ m
Calculation factor f	1.06
Calculation factor f_1	1
Calculation factor f_{2A}	1
Calculation factor f_{2B}	1.03
Calculation factor f_{2C}	1.05
Calculation factor f_{HC}	1



NTN BEARING CORP.

Calculation factor f_0	8.2
Mass bearing	0.24 kg