

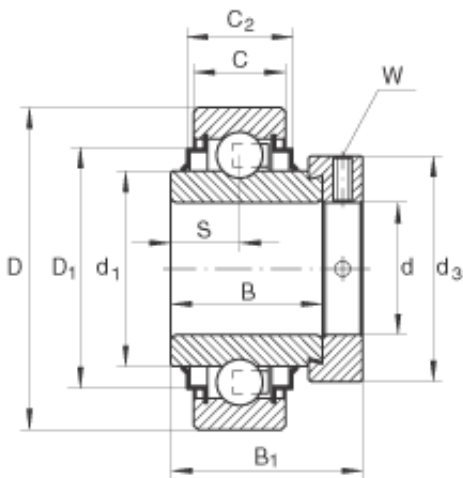

NTN BEARING CORP.



70 mm x 125 mm x 48,5 mm INA E70-KRR
deep groove ball bearings

Bearing No. E70-KRR

E70-KRR Bearing 2D drawings and 3D CAD models

| | |
|----------------------|--|
| Size | 70x125x66 mm |
| Bore Diameter | 70 mm |
| Outer Diameter | 125 mm |
| Width | 66 mm |
| d | 70 mm |
| D | 125 mm |
| B ₁ | 66 mm |
| B | 48,5 mm |
| C | 28 mm |
| C ₂ | 32 mm |
| D ₁ | 109 mm |
| d ₁ | 85,2 mm |
| d _{3 max} | 96 mm |
| S | 21,5 mm |
| W | 6 mm |
| m | 2,45 kg / Weight |
| C _r | 66000 N / Dynamic load rating (radial) |
| C _{0r} | 44000 N / Static load rating (radial) |
| Category | Insert Bearings Cylindrical OD |
| Inventory | 0.0 |
| Manufacturer Name | SCHAEFFLER GROUP |
| Minimum Buy Quantity | N/A |
| UNSPSC | 31171536 |



NTN BEARING CORP.

| | |
|--------------------|--|
| Weight / Kilogram | 2.395 |
| EAN | 4012802794526 |
| Product Group | M06110 |
| Inner Race Profile | Wide Inner Ring |
| Outer Race Profile | Cylindrical |
| Mounting Method | Eccentric Collar |
| Rolling Element | Ball Bearing |
| Relubricatable | No |
| Seal Type | Double Land Riding Rubber Contact |
| Snap Ring | No |
| Inch - Metric | Metric |
| Long Description | 70MM Bore; Wide Inner Ring; 28MM Outer Race Width; 125MM Outside Diameter; Eccentric Collar; Ball Bearing; 66MM Length Thru Bore; Not Relubricatable; Double Land Riding Rubber Contact Seal; No Snap Ri |
| Other Features | Single Row Metric |
| Bore | 2.756 Inch 70 Millimeter |
| Outer Race Width | 1.102 Inch 28 Millimeter |
| Outside Diameter | 4.921 Inch 125 Millimeter |
| Length Thru Bore | 2.598 Inch 66 Millimeter |