

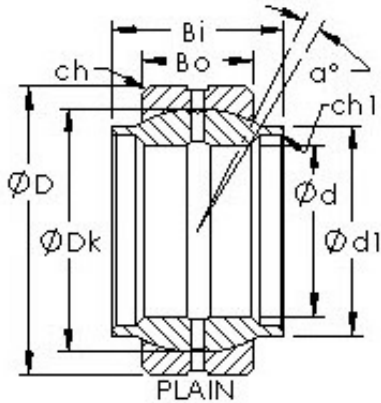

# NTN BEARING CORP.



## AST GEWZ63ES plain bearings

Bearing No. GEWZ63ES

Bore Diameter	63,5 mm
Outer Diameter	100,0125 mm
Bearing Type	plain
Bore Dia (d)	2.5000
Outer Dia (D)	3.9375
Outer Width (Bo)	1.8750
Inner Width (Bi)	3.7500
Dynamic Load Rating (Cr)	79,802
Static Load Rating (Cor)	238,283
Max. shaft corner radius, or 45 deg. chamfer (ch1)	0.040
Max. housing corner radius, or 45 deg. chamfer (ch)	0.040
Spherical Diameter (dk or Dk)	3.622
Mis-alignment Angle (a deg.)	5
Extended Inner OD (d1)	3.060
Weight (g)	2,150.00
Material	52100 chrome steel, or equivalent

GEWZ63ES Bearing 2D drawings and 3D CAD models