

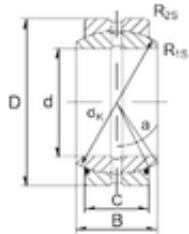

# NTN BEARING CORP.

100 mm x 150 mm x 70 mm ZEN GE100ES  
plain bearings



Bearing No. GE100ES

Size	100x150x70 mm
Bore Diameter	100 mm
Outer Diameter	150 mm
Width	70 mm
d	100 mm
D	150 mm
B	70 mm
C	55 mm
dk	130 mm
r1 min.	1 mm
r2 min.	1 mm
Angle	7 °
Weight	4,45 Kg
Basic dynamic load rating (C)	607 kN

GE100ES Bearing 2D drawings and 3D CAD models