

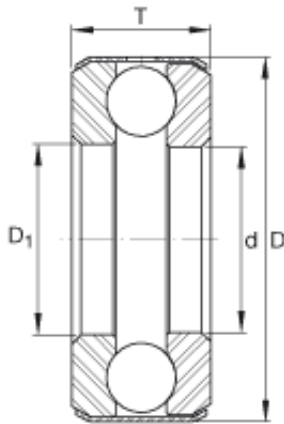

NTN BEARING CORP.



INA D21 thrust ball bearings

Bearing No. D21

D21 Bearing 2D drawings and 3D CAD models

Size	44.45x78.588x20.65 mm
Bore Diameter	44,45 mm
Outer Diameter	78,588 mm
Width	20,65 mm
d	1 3/4 inch
d	44,45 mm
D	3,094 inch
D	78,588 mm
T	0,813 inch
T	20,65 mm
D ₁	1,781 inch
m	0,9 lbs / Weight
m	406 g / Weight
C _a	10600 lbf / Dynamic load rating (axial)
C _a	47000 N / Dynamic load rating (axial)
C _{0a}	26500 lbf / Static load rating (axial)
C _{0a}	118000 N / Static load rating (axial)
Category	Thrust Ball Bearing
Inventory	0.0
Manufacturer Name	SCHAEFFLER GROUP
Minimum Buy Quantity	N/A
Weight / Kilogram	0.406
EAN	4012802034509



NTN BEARING CORP.

Product Group	B00308
Rolling Element	Ball Bearing
Thrust Bearing	Yes
Single or Double Direction	Single Direction
Banded	Yes
Cage Material	Steel
Precision Class	ABEC 1 ISO P0
Component Description	Roller Assembly Plus Raceways
Other Features	Single Row
Long Description	1-3/4" Bore 1; 1-25/32" Bore 2; 3-3/32" Outside Diameter; 13/16" Height; Ball Bearing; Single Direction; Banded; Steel Cage; ABEC 1 ISO P0 Precision
Inch - Metric	Inch
Category	Thrust Ball Bearings
UNSPSC	31171552
Harmonized Tariff Code	8482.10.50.08
Noun	Bearing
Keyword String	Ball Thrust
Manufacturer URL	http://www.ina.com
Weight / LBS	0.887
Bore 1	1.75 Inch 44.45 Millimeter
Outside Diameter	3.094 Inch 78.588 Millimeter
Overall Height with Aligning Washer	0 Inch 0 Millimeter
Bore 2	1.781 Inch 45.237 Millimeter
Height	0.813 Inch 20.65 Millimeter